

1 **EXAMPLE POST LAYOUT**
PLAN VIEW

NOTES:

1. TOP RAIL NOT SHOWN FOR CLARITY.
2. ALL PARTS AND COMPONENTS MADE WITH 316 STAINLESS STEEL UNLESS NOTED OTHERWISE.

LEGEND

- DETAIL ID
- SHEET ID
- ELEVATION ID
- SHEET ID
- CORE DRILL POST
- CORE DRILL DOUBLE POST
- CENTERLINE
- FF** FINISHED FLOOR
- TYP TYPICAL CONDITION APPLIES ELSEWHERE AT SIMILAR CONDITIONS

NOTES:

1. STAIR CONSTRUCTION VARIES GREATLY. AS-BUILT CONDITIONS MAY ALTER RAILING DESIGN, INCLUDING POST LOCATION & MOUNTING, INFILL SPACING, AND TOP RAIL LAYOUT.

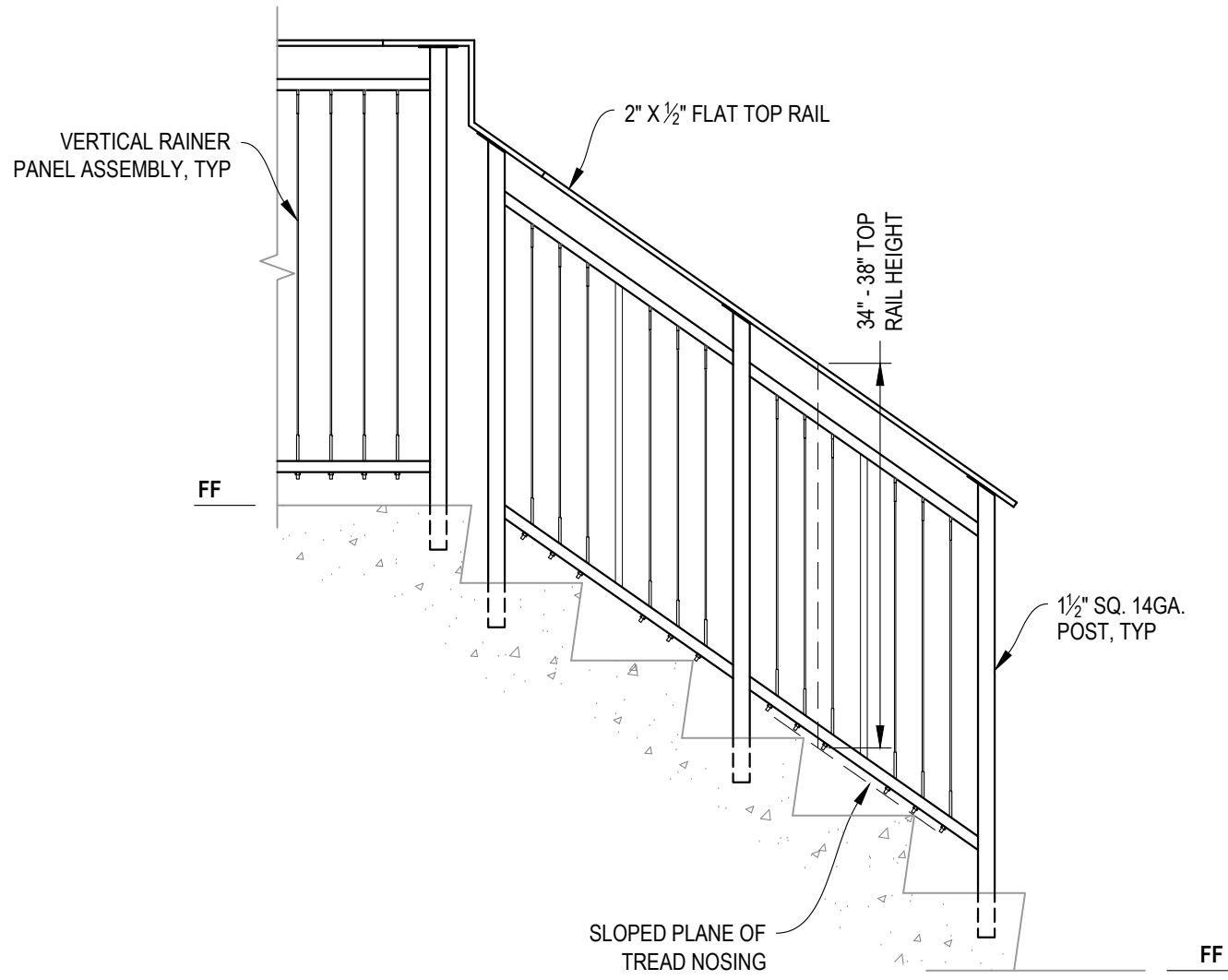

A STAIR
ELEVATION

AGS Stainless Clearview® Railing Systems are designed to meet the requirements of the latest edition of the IRC/IBC.

VERTICAL RAINER SPECIFICATION DRAWING
** RESIDENTIAL **

42" CORE DRILL - FLAT TOP

DWG # CD42F
SCALE NONE
DATE 2026
SHEET

3 OF **5**



7873 NEDAY ROAD
BAINBRIDGE ISLAND, WA 98110
PHONE - (888) 842-9492
WWW.AGSSTAINLESS.COM



NOTE: 90° SHOWN, OTHER ANGLES SIMILAR

A TYPICAL 90° TOP MOUNT OUTSIDE CORNER
DETAIL



NOTE: 90° SHOWN, OTHER ANGLES SIMILAR

B TYPICAL 90° TOP MOUNT INSIDE CORNER
DETAIL

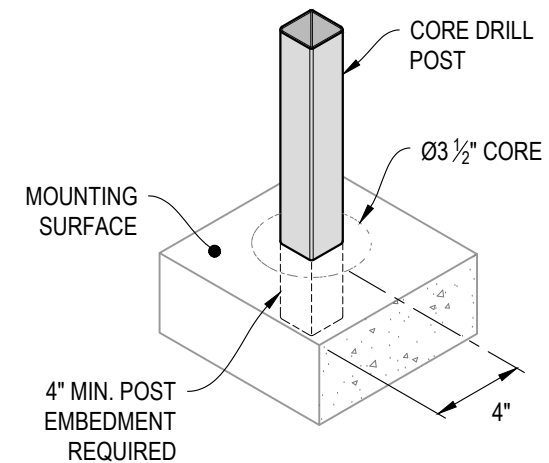

C TYPICAL POST MOUNTING - CORE DRILL
DETAIL

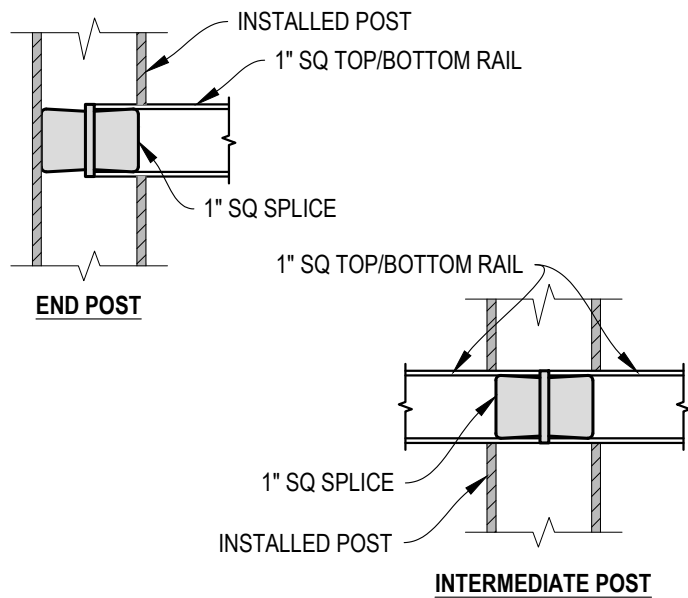

D FITTING INSTALLATION - VERTICAL PANEL RAIL SPLICE
DETAIL

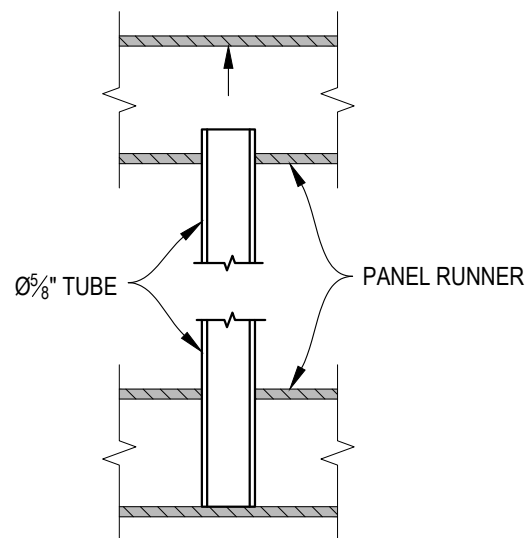

E PANEL SUPPORT TUBE INSTALLATION
DETAIL

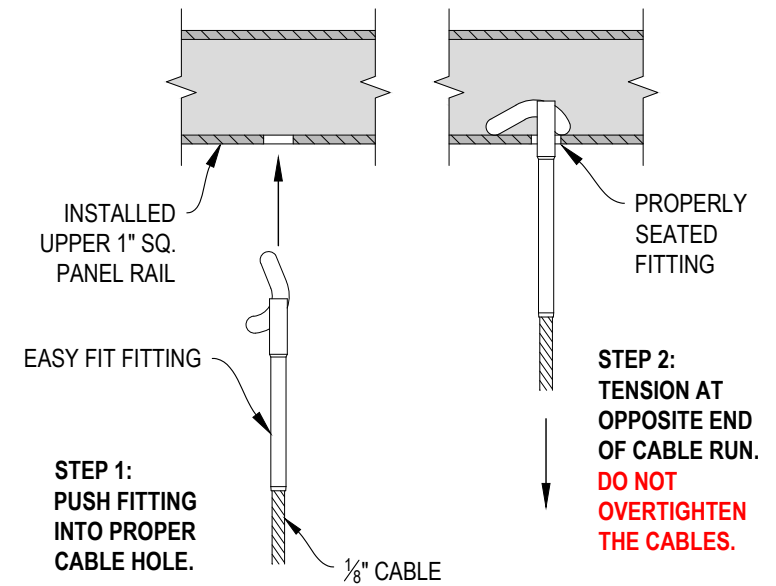

F FITTING INSTALLATION - EASY FIT
DETAIL

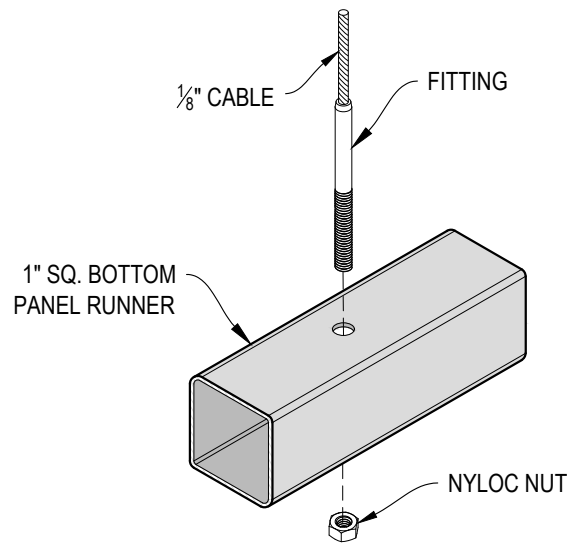

A FITTING INSTALLATION - STANDARD
DETAIL

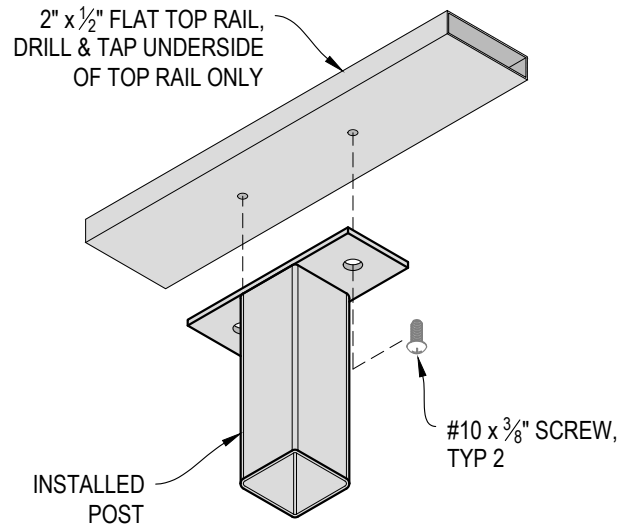

B TOP RAIL INSTALLATION - FLAT
DETAIL

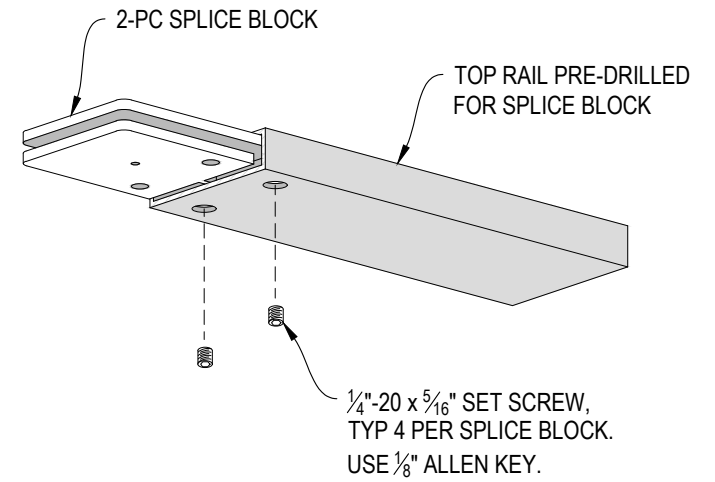

C SPLICE BLOCK ASSEMBLY - FLAT
DETAIL