

**A** **TYPICAL RAILING CONDITION**  
ELEVATION

**NOTES:**

1. TOP RAIL SHOULD BE SELECTED SO THAT ALL GOVERNING CODE REQUIREMENTS ARE SATISFIED. THESE INCLUDE SHAPE, STRENGTH AND RAILING HEIGHT.
2. DECK STRUCTURE CAN VARY GREATLY. IT IS THE RESPONSIBILITY OF THE CUSTOMER TO VERIFY THAT THE SUPPORTING STRUCTURE IS ADEQUATE TO MEET THE LOAD REQUIREMENTS OF THE GOVERNING BUILDING CODE(S). *AGS Stainless Inc.* RECOMMENDS CONSULTING A DESIGN OR CONSTRUCTION PROFESSIONAL TO ADDRESS THESE ISSUES.

RAINIER SPECIFICATION DRAWING  
\*\* RESIDENTIAL \*\*

42" SIDE MOUNT - WOOD TOP

DWG #	SM42W
SCALE	NONE
DATE	2026
SHEET	

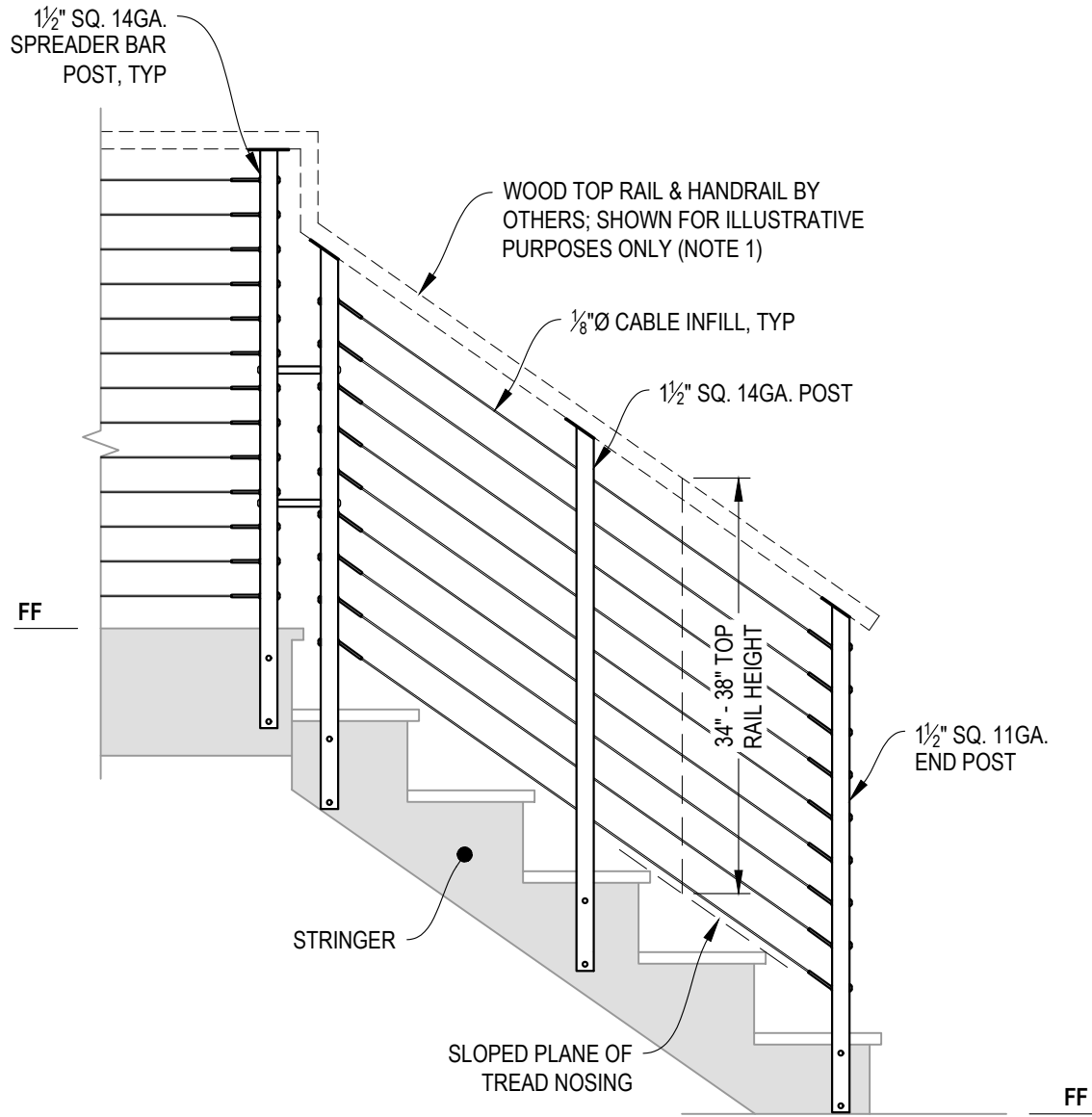

**A** STAIR ELEVATION

**NOTES:**

1. TOP RAIL SHOULD BE SELECTED SO THAT ALL GOVERNING CODE REQUIREMENTS ARE SATISFIED. THESE INCLUDE SHAPE, STRENGTH, AND RAILING HEIGHT.
2. STAIR CONSTRUCTION VARIES GREATLY. AS-BUILT CONDITIONS MAY ALTER RAILING DESIGN, INCLUDING POST LOCATION & MOUNTING, INFILL SPACING, AND TOP RAIL LAYOUT.

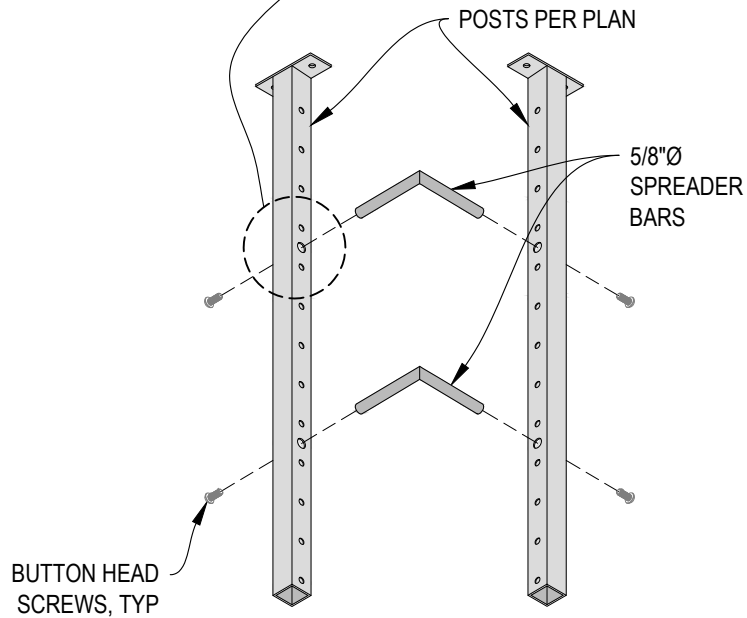
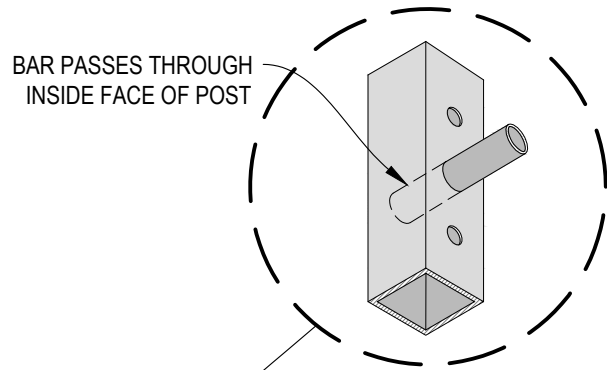

**A** CORNER POST ASSEMBLY  
DETAIL

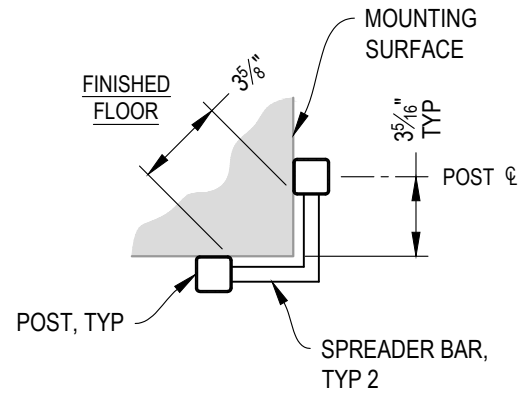

NOTE: 90° SHOWN, OTHER ANGLES SIMILAR

**B** TYPICAL 90° SIDE MOUNT OUTSIDE CORNER  
DETAIL

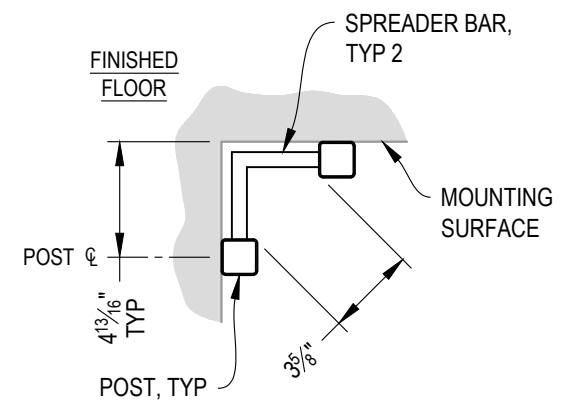

NOTE: 90° SHOWN, OTHER ANGLES SIMILAR

**C** TYPICAL 90° SIDE MOUNT INSIDE CORNER  
DETAIL

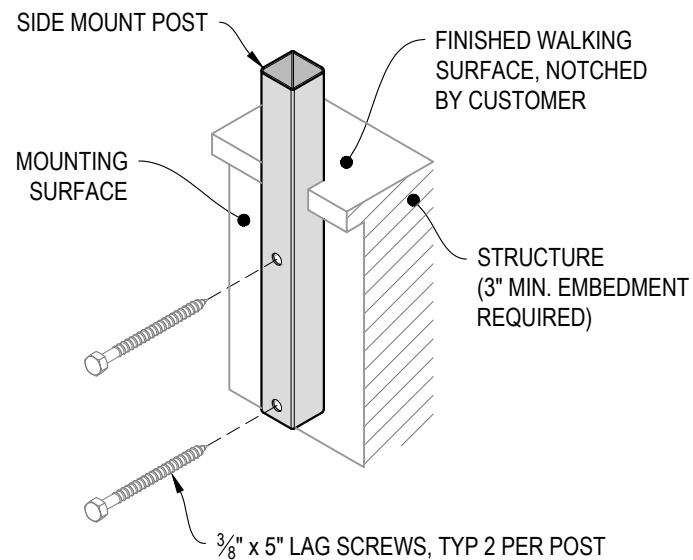

**D** TYPICAL POST MOUNTING - SIDE MOUNT  
DETAIL

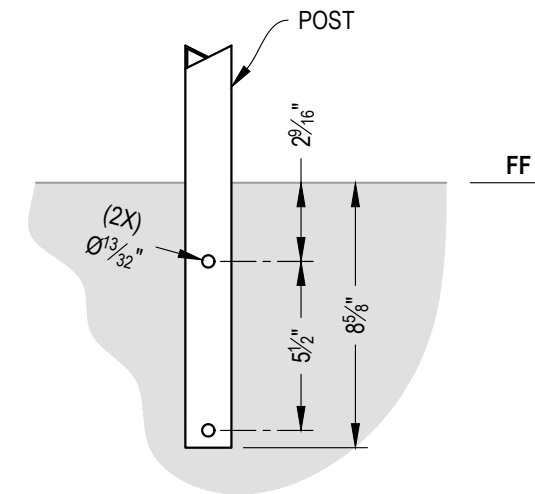

**E** TYPICAL POST MOUNTING - SIDE MOUNT  
DETAIL

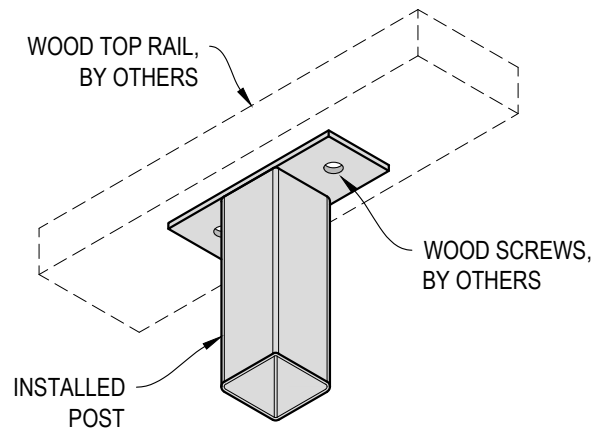

**A** TOP RAIL INSTALLATION - WOOD  
DETAIL

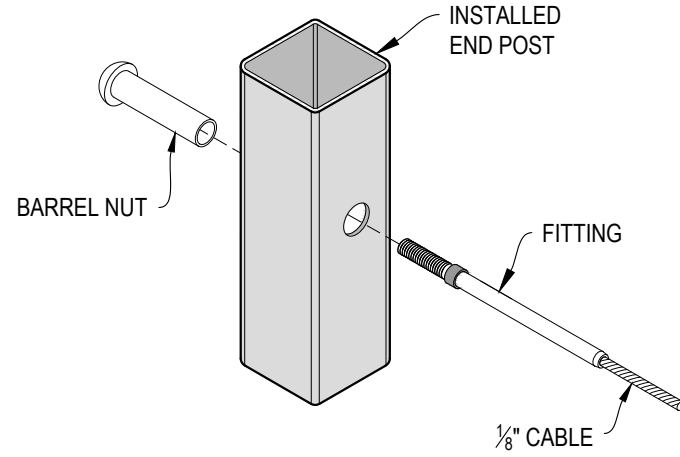

**B** FITTING INSTALLATION - BARREL NUT  
DETAIL