

**1** EXAMPLE POST LAYOUT  
PLAN VIEW

AGS Stainless Clearview® Railing Systems are designed to meet the requirements of the latest edition of the IRC/IBC.

**NOTES:**

1. TOP RAIL NOT SHOWN FOR CLARITY.
2. ALL PARTS AND COMPONENTS MADE WITH 316 STAINLESS STEEL UNLESS NOTED OTHERWISE.

**LEGEND**

- DETAIL ID
- SHEET ID
- ELEVATION ID
- SHEET ID
- SIDE MOUNT POST
- SIDE MOUNT DOUBLE POST
- CENTERLINE
- FINISHED FLOOR
- TYP TYPICAL CONDITION APPLIES ELSEWHERE AT SIMILAR CONDITIONS

7873 NE DAY ROAD  
BAINBRIDGE ISLAND, WA 98110  
PHONE - (888) 842-9492  
WWW.AGSSTAINLESS.COM

**AGS stainless**  
CLEARVIEW® Railing Systems

VERTICAL OLYMPUS SPECIFICATION DRAWING  
\*\* COMMERCIAL \*\*

**42" SIDE MOUNT - ROUND TOP**

DWG #	SM42RC
SCALE	NONE
DATE	2026
SHEET	<b>1</b> OF 5

**NOTES:**

1. DECK STRUCTURE CAN VARY GREATLY. IT IS THE RESPONSIBILITY OF THE CUSTOMER TO VERIFY THAT THE SUPPORTING STRUCTURE IS ADEQUATE TO MEET THE LOAD REQUIREMENTS OF THE GOVERNING BUILDING CODE(S). *AGS Stainless Inc.* RECOMMENDS CONSULTING A DESIGN OR CONSTRUCTION PROFESSIONAL TO ADDRESS THESE ISSUES.

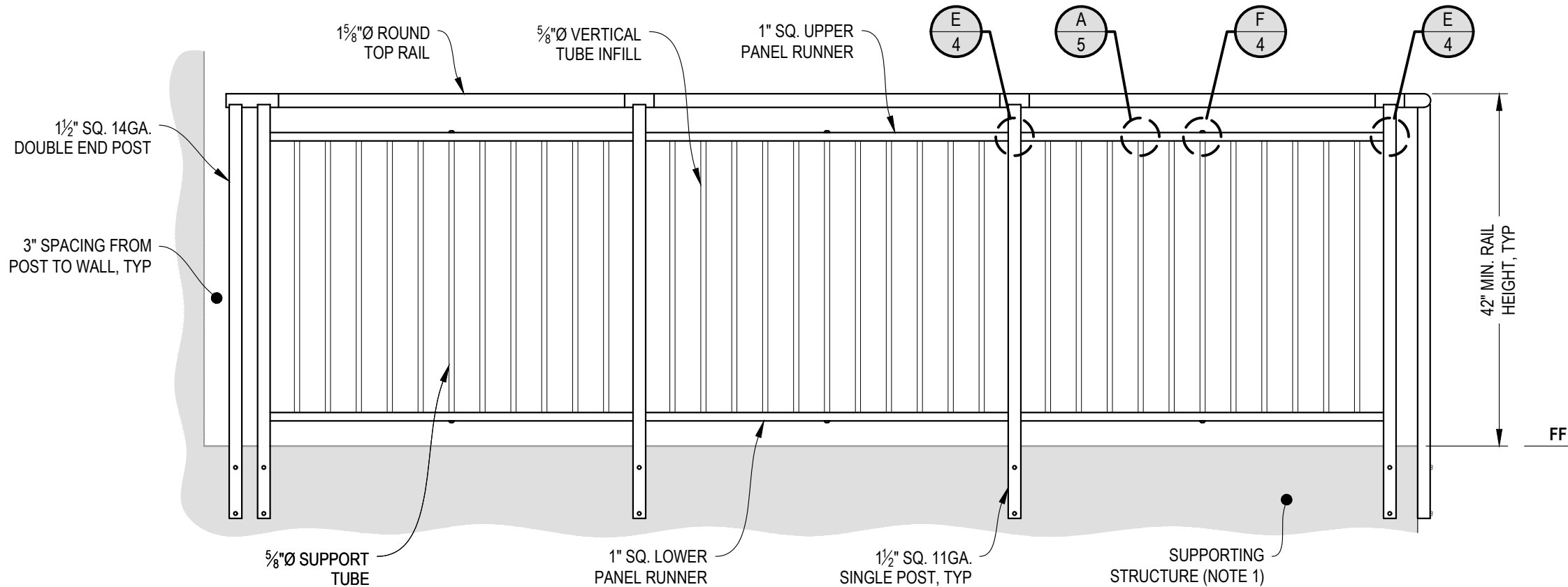

**END POST - WALL CONDITION**

**INTERMEDIATE POST CONDITION**

**CORNER POST CONDITION**

**A TYPICAL RAILING CONDITION ELEVATION**

VERTICAL OLYMPUS SPECIFICATION DRAWING  
\*\* COMMERCIAL \*\*

42" SIDE MOUNT - ROUND TOP

DWG # SM42RC  
SCALE NONE  
DATE 2026  
SHEET

**2** OF 5

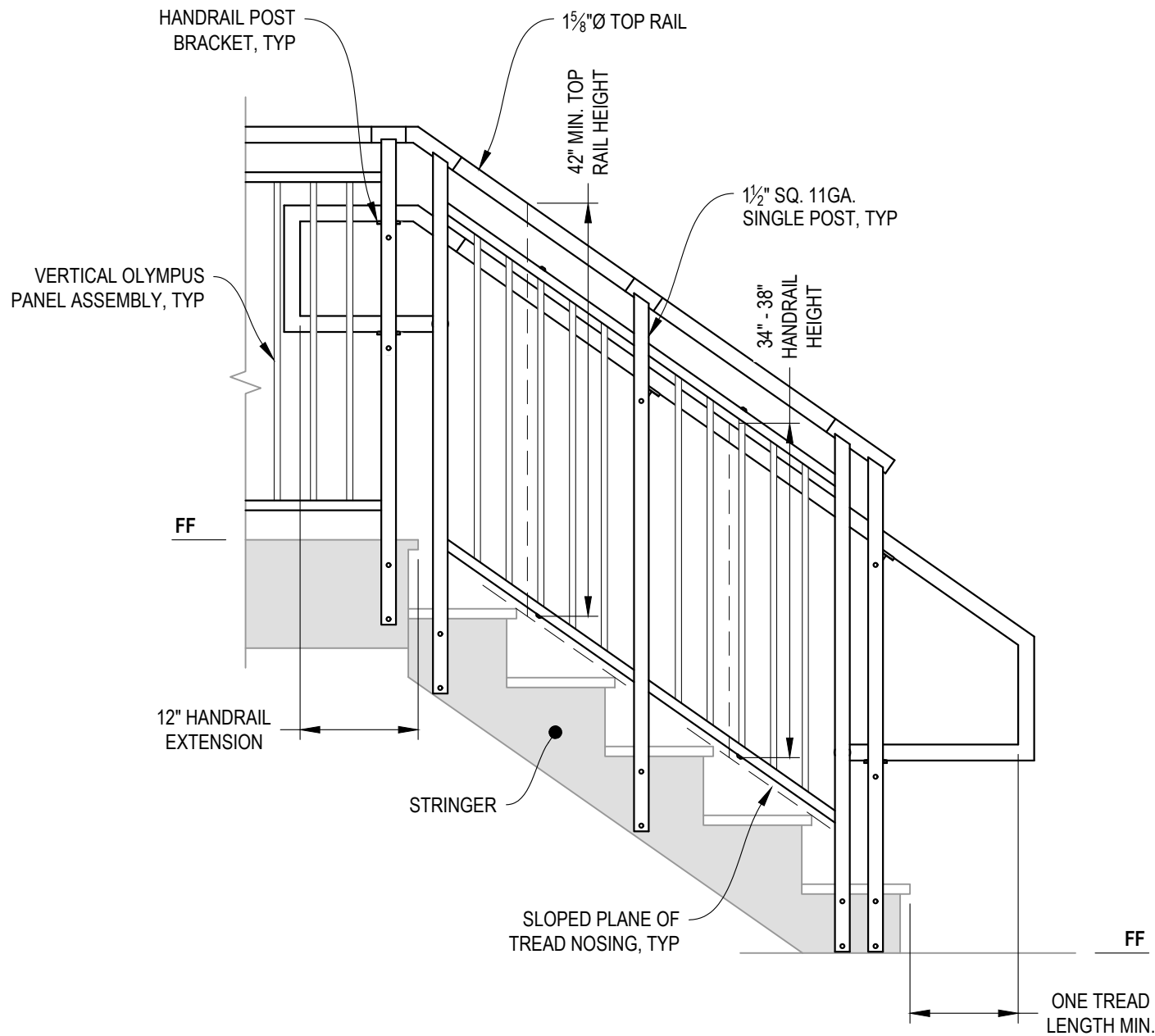

**A** STAIR  
ELEVATION

**NOTES:**

1. STAIR CONSTRUCTION VARIES GREATLY. AS-BUILT CONDITIONS MAY ALTER RAILING DESIGN, INCLUDING POST LOCATION & MOUNTING, INFILL SPACING, AND TOP RAIL LAYOUT.

AGS Stainless Clearview® Railing Systems are designed to meet the requirements of the latest edition of the IRC/IBC.

7873 NEDAY ROAD  
BAINBRIDGE ISLAND, WA 98110  
PHONE - (888) 842-9492  
WWW.AGSSTAINLESS.COM

**AGS stainless**  
CLEARVIEW® Railing Systems

VERTICAL OLYMPUS SPECIFICATION DRAWING  
\*\* COMMERCIAL \*\*  
42" SIDE MOUNT - ROUND TOP

DWG #	SM42RC
SCALE	NONE
DATE	2026
SHEET	<b>3</b> OF <b>5</b>

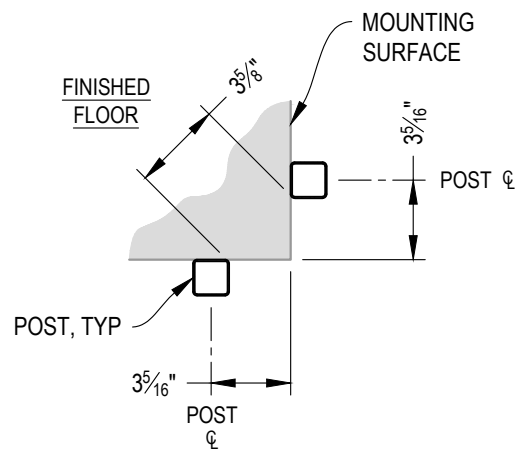

NOTE: 90° SHOWN, OTHER ANGLES SIMILAR

**A** TYPICAL 90° SIDE MOUNT OUTSIDE CORNER  
DETAIL

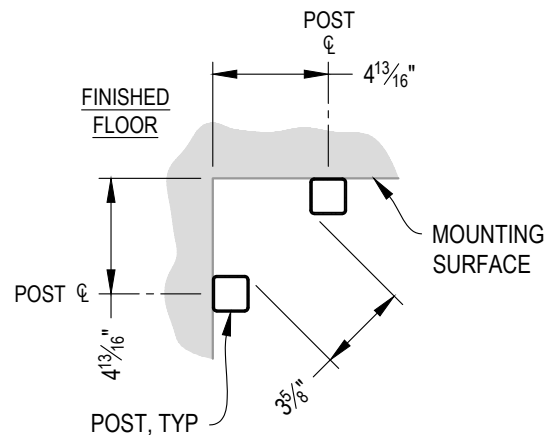

NOTE: 90° SHOWN, OTHER ANGLES SIMILAR

**B** TYPICAL 90° SIDE MOUNT INSIDE CORNER  
DETAIL

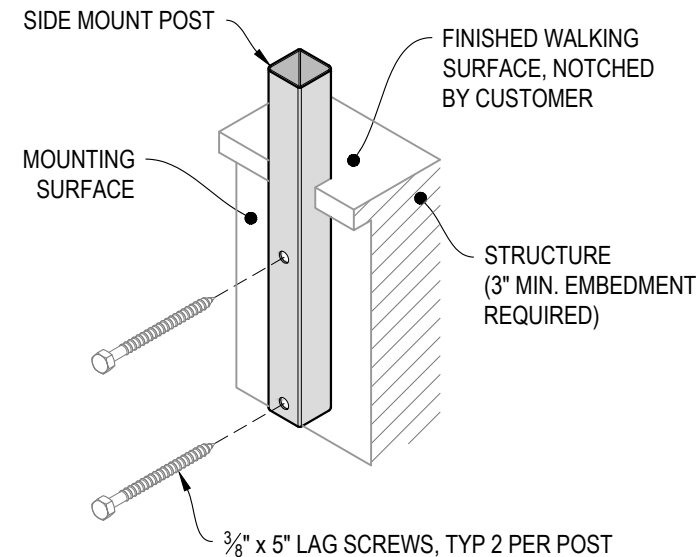

**C** TYPICAL POST MOUNTING - SIDE MOUNT  
DETAIL

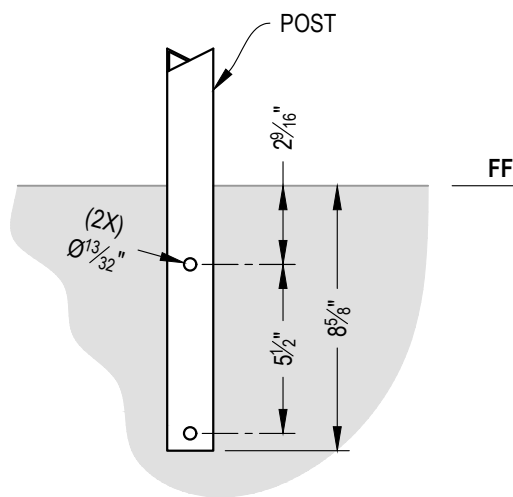

**D** TYPICAL POST MOUNTING - SIDE MOUNT  
DETAIL

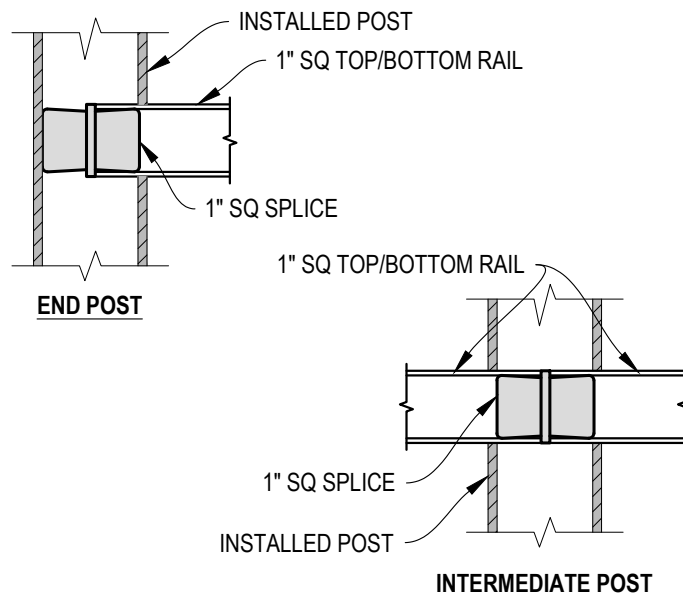

**E** FITTING INSTALLATION - VERTICAL PANEL RAIL SPLICE  
DETAIL

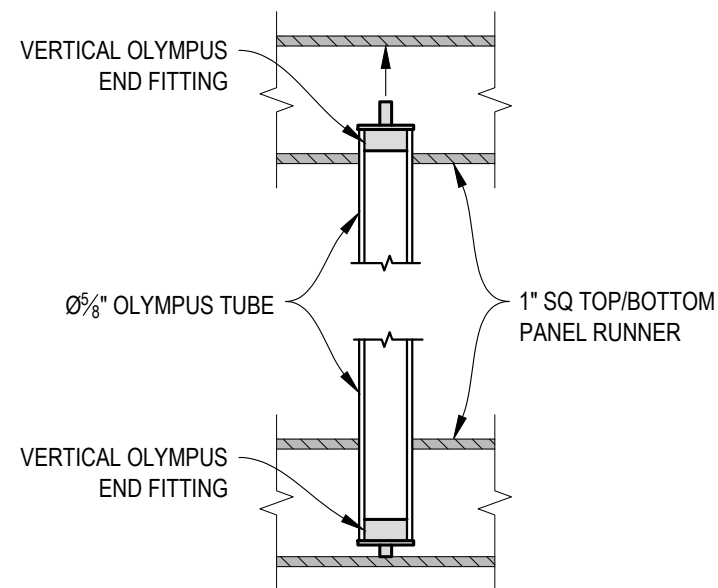

**F** FITTING INSTALLATION - OLYMPUS INSERT  
DETAIL

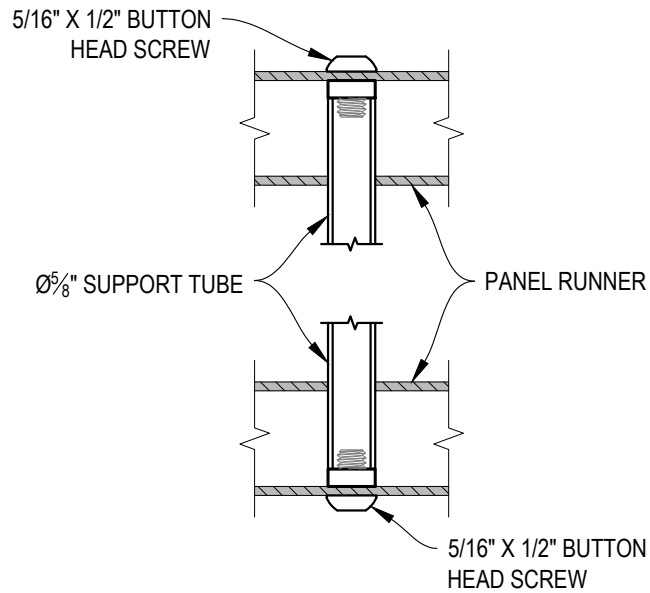

**A** FITTING INSTALLATION - MIDDLE SUPPORT TUBE  
DETAIL

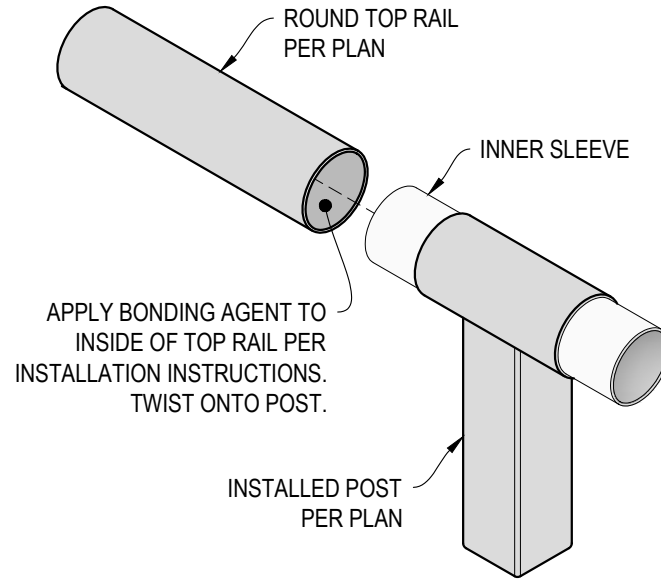

**B** TOP RAIL INSTALLATION - ROUND  
DETAIL

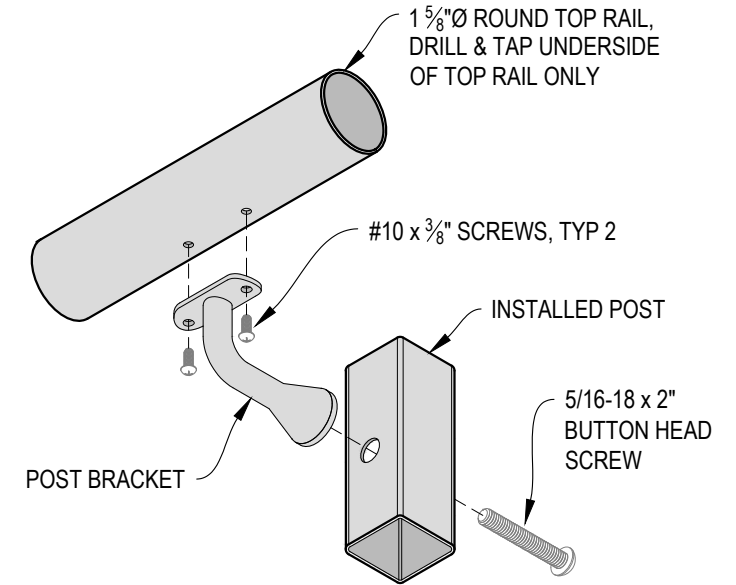

**C** HANDRAIL POST BRACKET INSTALLATION - ROUND  
DETAIL

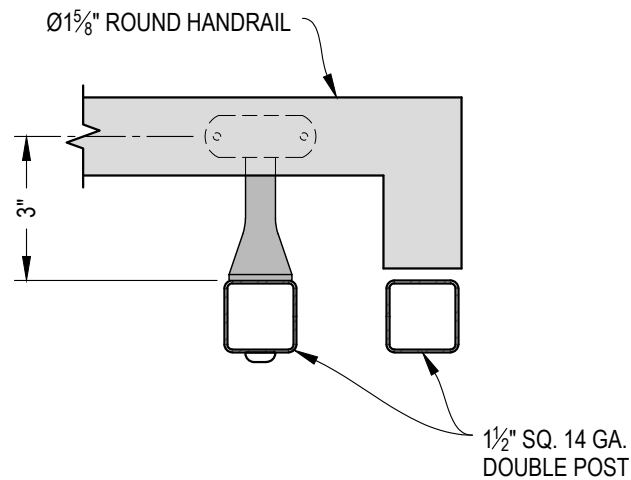

**NOTE: VIEW MAY BE MIRRORED**

**D** TYPICAL HANDRAIL RETURN - ROUND  
DETAIL