

1 **EXAMPLE POST LAYOUT**
PLAN VIEW

AGS Stainless Clearview® Railing Systems are designed to meet the requirements of the latest edition of the IRC/IBC.

NOTES:

1. TOP RAIL NOT SHOWN FOR CLARITY.
2. ALL PARTS AND COMPONENTS MADE WITH 316 STAINLESS STEEL UNLESS NOTED OTHERWISE.

LEGEND

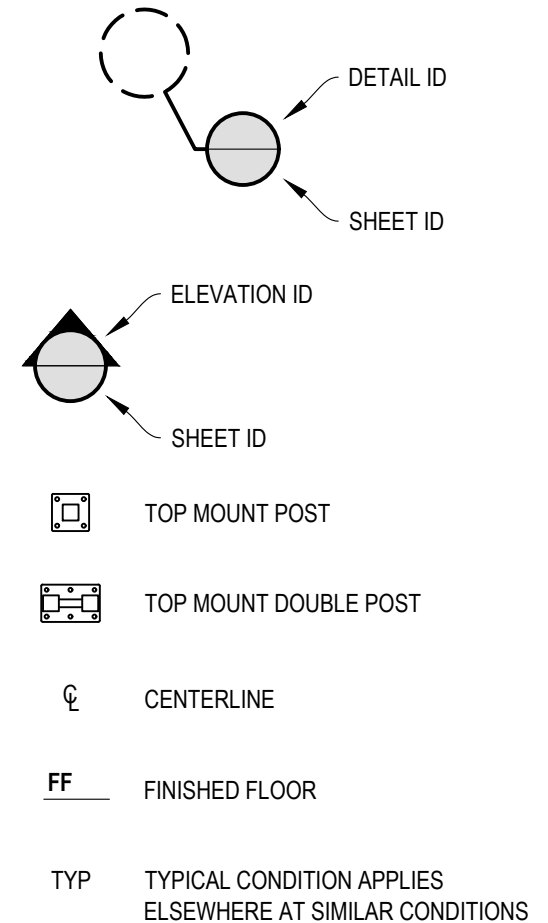

NOTES:

1. DECK STRUCTURE CAN VARY GREATLY. IT IS THE RESPONSIBILITY OF THE CUSTOMER TO VERIFY THAT THE SUPPORTING STRUCTURE IS ADEQUATE TO MEET THE LOAD REQUIREMENTS OF THE GOVERNING BUILDING CODE(S). *AGS Stainless Inc.* RECOMMENDS CONSULTING A DESIGN OR CONSTRUCTION PROFESSIONAL TO ADDRESS THESE ISSUES.

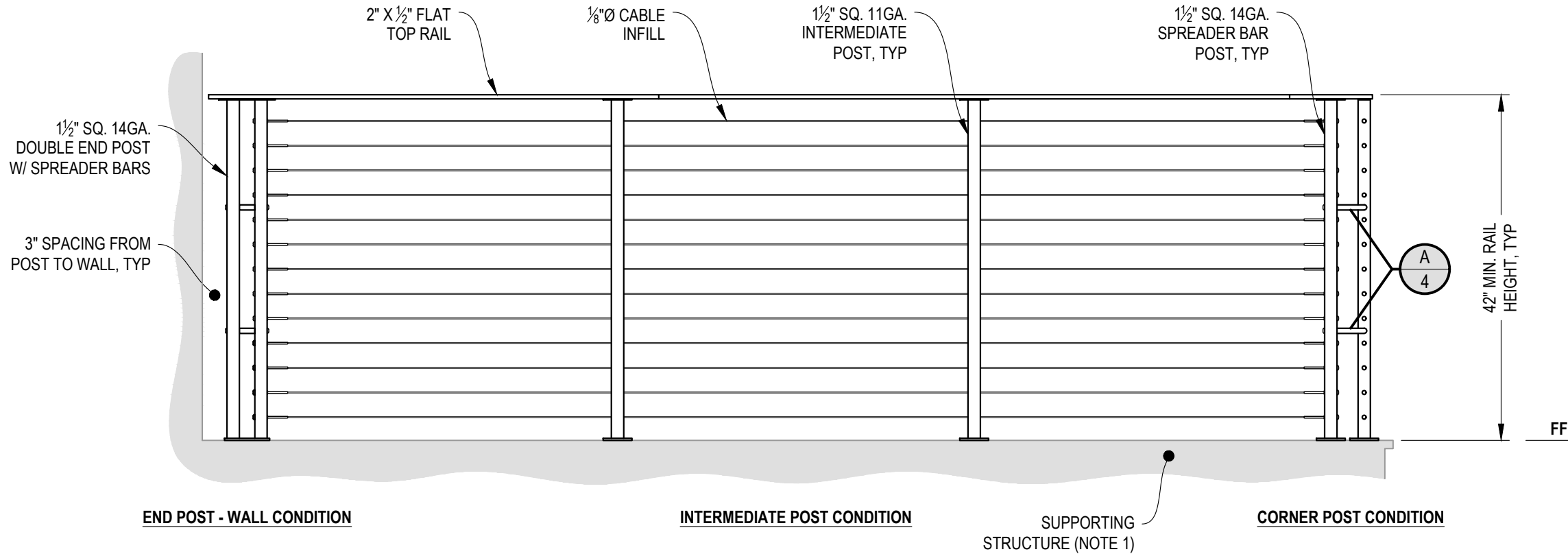

A **TYPICAL RAILING CONDITION**
ELEVATION

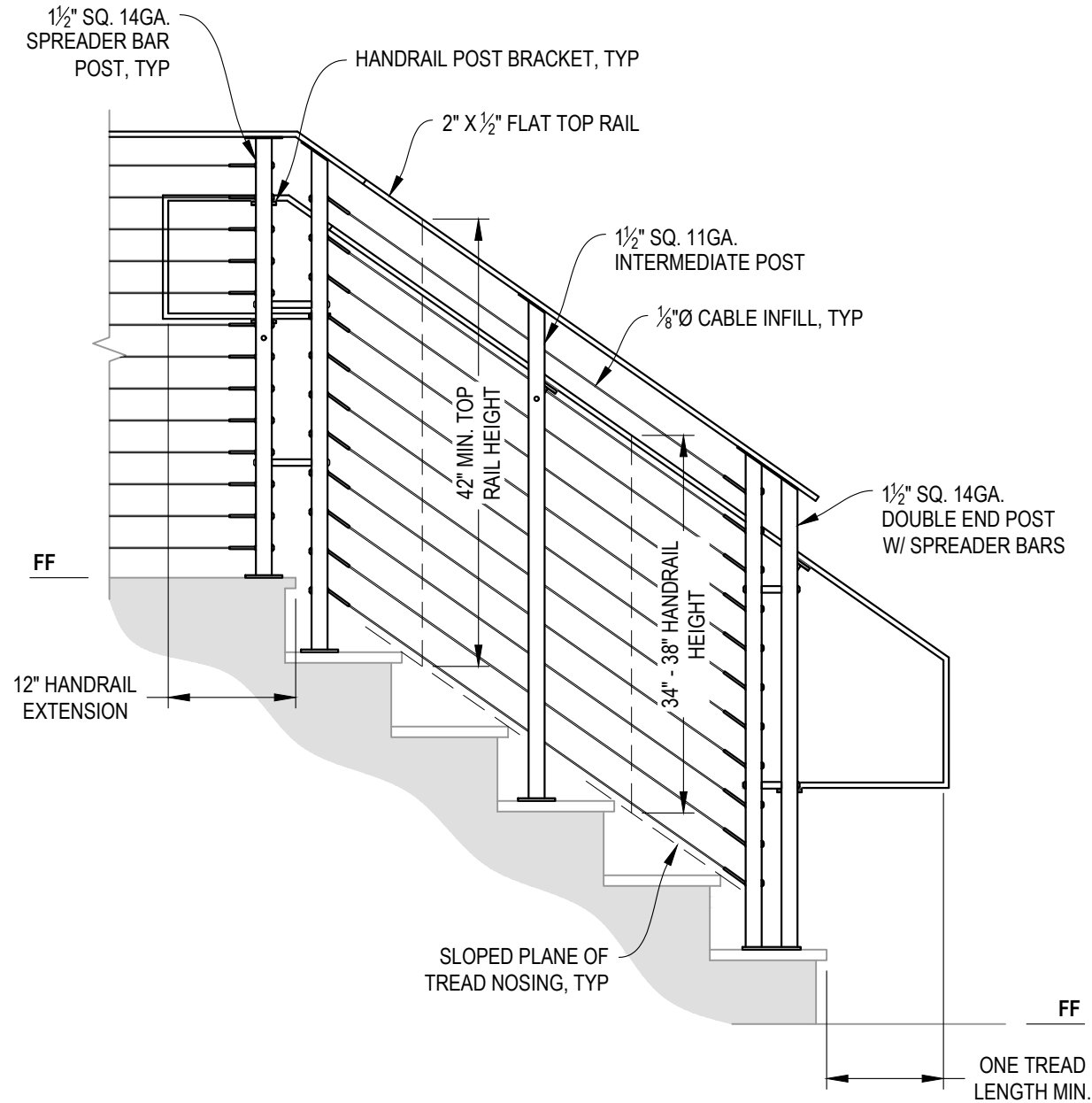

A STAIR
ELEVATION

NOTES:

1. STAIR CONSTRUCTION VARIES GREATLY. AS-BUILT CONDITIONS MAY ALTER RAILING DESIGN, INCLUDING POST LOCATION & MOUNTING, INFILL SPACING, AND TOP RAIL LAYOUT.

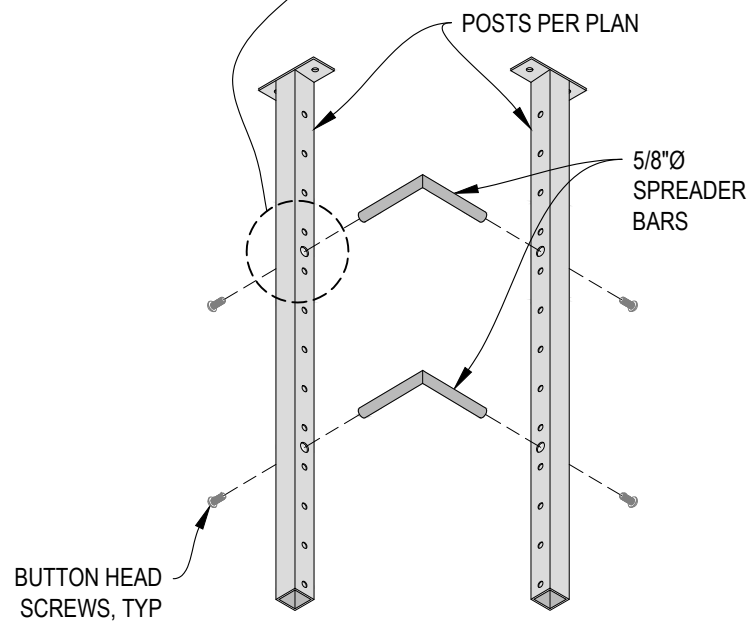
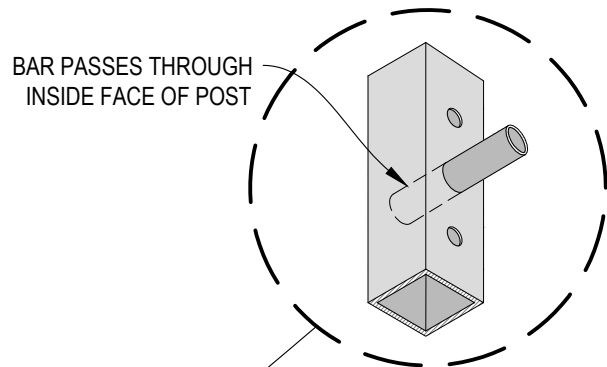

A CORNER POST ASSEMBLY
DETAIL

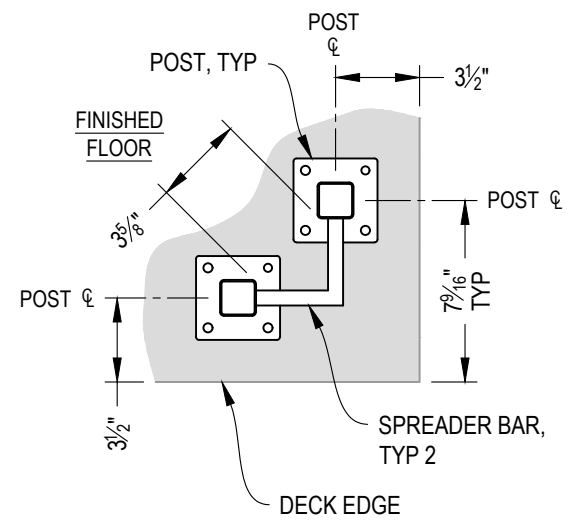

NOTE: 90° SHOWN, OTHER ANGLES SIMILAR

B TYPICAL 90° TOP MOUNT OUTSIDE CORNER
DETAIL

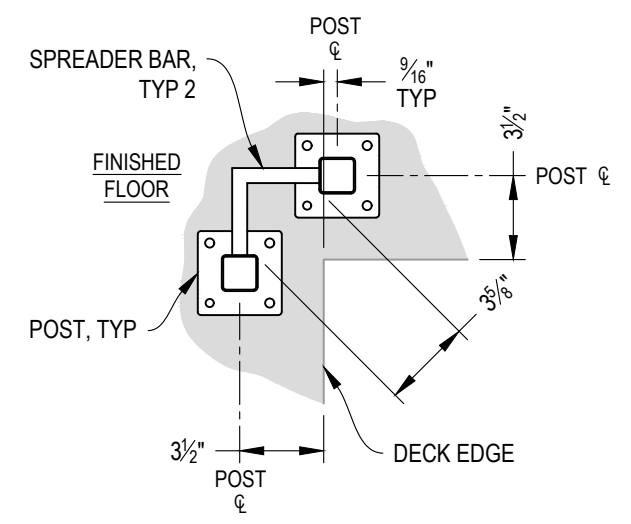

NOTE: 90° SHOWN, OTHER ANGLES SIMILAR

C TYPICAL 90° TOP MOUNT INSIDE CORNER
DETAIL

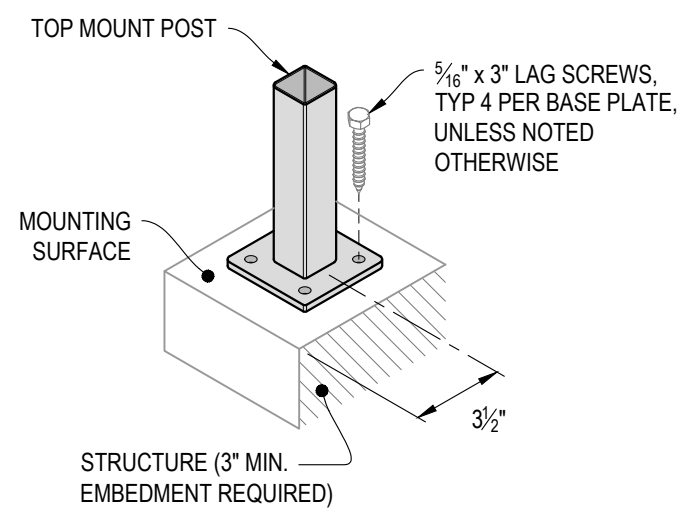

D TYPICAL POST MOUNTING - TOP MOUNT
DETAIL

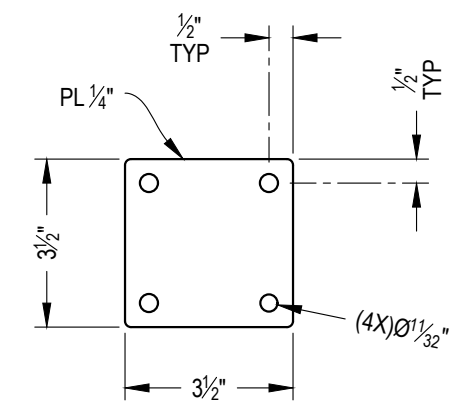

E TYPICAL BASE PLATE
DETAIL

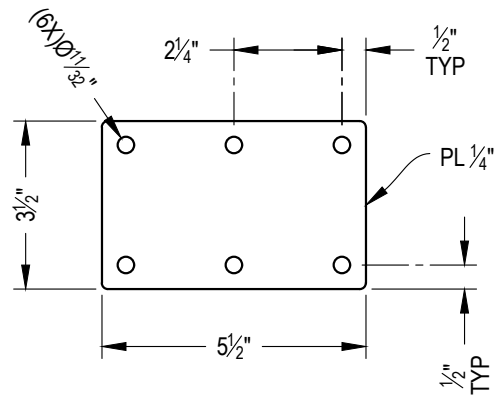

A TYPICAL DOUBLE BASE PLATE
DETAIL

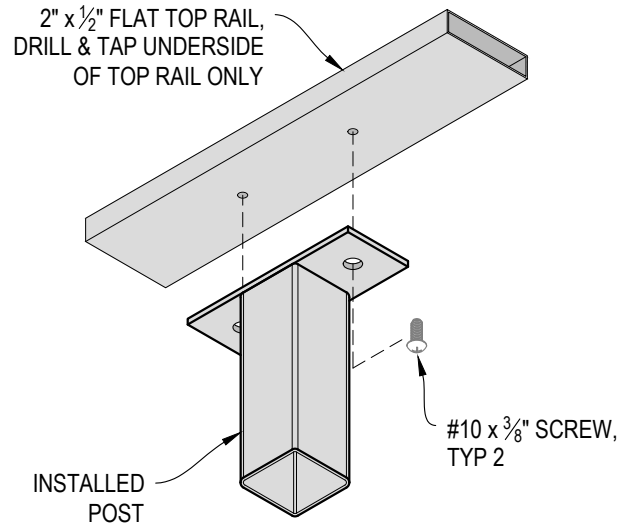

B TOP RAIL INSTALLATION - FLAT
DETAIL

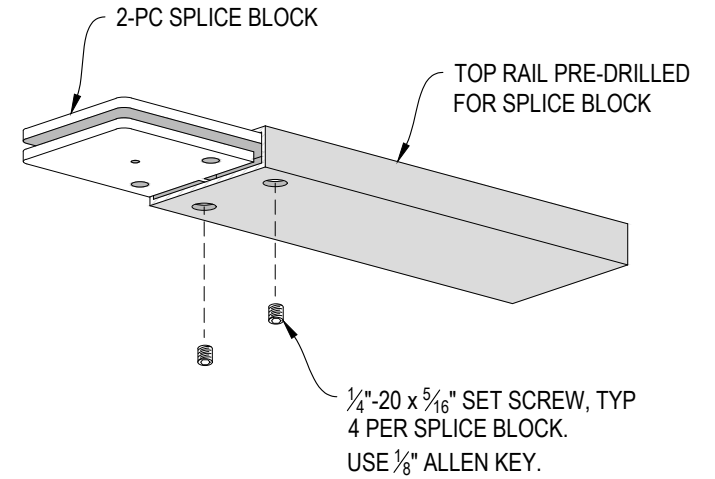

C SPLICE BLOCK ASSEMBLY - FLAT
DETAIL

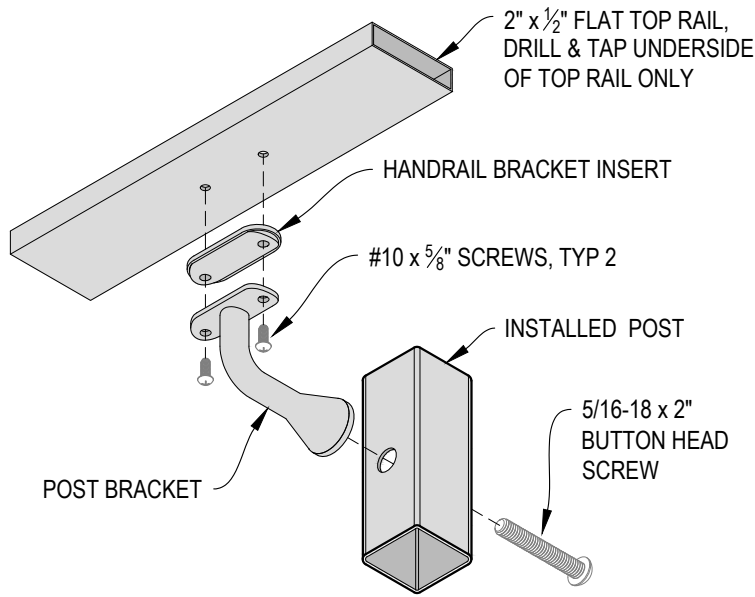

D HANDRAIL POST BRACKET INSTALLATION - FLAT
DETAIL

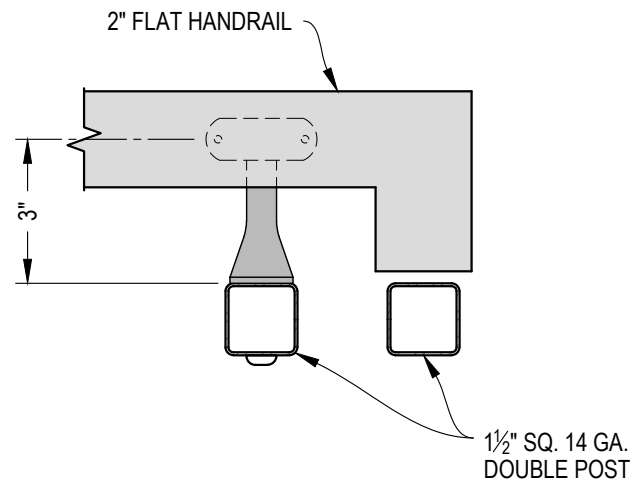

NOTE: VIEW MAY BE MIRRORED

E TYPICAL HANDRAIL RETURN - FLAT
DETAIL

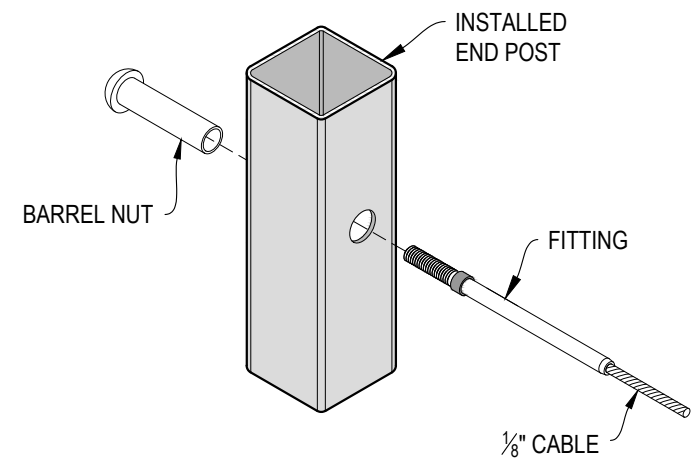

F FITTING INSTALLATION - BARREL NUT
DETAIL